

## BEAM CLAMP

### Model: BC

- ◆ Conforms to ANSI/ASME safety standard.
- ◆ Can be easy with threaded handle.
- ◆ Clamp jaw is designed to reduce flange stress by distributing from I-Beam flange edge.
- ◆ Fits a wide range of flange width and beams.
- ◆ Suspension bar provides lower headroom.

### OPTIONAL EXTRA

- ◆ Can be supplied with shackle.
- ◆ Specially design with flatened, reinforced jaws.

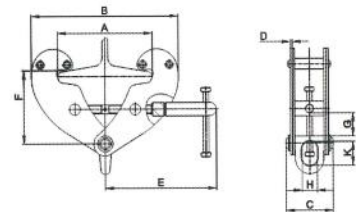

Model	Capacity (ton)	I-Beam Width (mm)	Dimensions(mm)											N.W. (Kg)	
			A		B		C	D	E	F		G	H		K
			Max.	Min.	Max.	Max.				Min.					
BC1	1	75-230	240	192	367	94	4	218	155	103	20	30	45	4.2	
BC2	2	75-230	240	192	367	102	6	218	155	103	20	30	45	5.1	
BC3	3	80-320	330	243	491	132	8	258	223	157	47	45	63	10.4	
BC5	5	80-320	330	243	491	142	10	258	223	157	47	45	63	12.2	
BC10	10	90-320	330	259	501	180	12	293	235	175	56	64	95	18.8	